

OPERATING MANUAL

PE-HD street installation boxes

Cat. no. 95xx



TABLE OF CONTENTS

1.	INTENDED USE.....	3
2.	TECHNICAL DESCRIPTION.....	3
3.	PRODUCT IDENTIFICATION.....	4
4.	STORAGE AND TRANSPORT.....	5
5.	INSTALLATION.....	5
6.	OPERATION AND MAINTENANCE	6
7.	SAFETY.....	6
8.	WARRANTY.....	6

1. INTENDED USE

Plastic street installation boxes, cat. no. 95XX with a body are used to secure access to water and gas pipeline gate valves, connections and adapter fittings installed underground.

2. TECHNICAL DESCRIPTION

Taking into account the installation method boxes for various valve types are designated as follows: “W” – for water pipeline gate valves and adapter fittings for water pipeline connections; “HYDRANT” for underground hydrants; “GAZ” for gas system gate valves; and “K” for sewage system fittings.

PEHD street installation boxes are resistant to temperatures up to +240°C.

Base plates made of PEHD constitute a necessary element of street installation boxes. The plates are square and come with a correctly profiled surface that facilitates seating a street installation box of a given type. The base plate distributes the pressure imposed by the box onto the larger surface.

Cat. no.	Characteristics	Installation location	Comments
9501	Round, cover made of grey or ductile cast iron, body made of PEHD, indication on the cover: W	Green areas, walkways, roadways - max. 125 kN	For pipeline gate valves
9502	Oval, cover made of grey cast iron, body made of PEHD, indication on the cover: HYDRANT	Green areas, walkways, roadways - max. 125 kN	For underground hydrants
9503	Round, cover made of grey cast iron, body made of PEHD, indication on the cover: W	Green areas, walkways	For connections
9504	Round, cover made of PEHD or grey cast iron, body made of PEHD, indication on the cover: W	Green areas	For adapter fittings
9505	Round, cover made of PEHD or grey cast iron, body made of PEHD, indication on the cover: GAZ	Green areas	For adapter fittings
9506	Round, cover made of grey cast iron, body made of PEHD, indication on the cover: GAZ	Green areas, walkways, roadways - max. 125 kN	For gas system gate valves
9507	Square, cover made of grey cast iron, body made of PEHD, indication on the cover: GAZ	Green areas, walkways, roadways - max. 125 kN	For gas system gate valves
9508	Oval, cover made of grey cast iron, body made of PEHD, indication on the cover: GAZ	Green areas, walkways, roadways - max. 125 kN	For gas system gate valves
9509	Round, adjustable height, cover made of grey cast iron, body made of PEHD, indication on the cover: W	Green areas, walkways, roadways - max. 125 kN	For pipeline gate valves
9511	Square, cover made of grey or ductile cast iron, body made of PEHD, indication on the cover: W	Green areas, walkways, roadways - max. 125 kN	For pipeline gate valves
9512	Round, cover made of grey or ductile cast iron, body made of PEHD, indication on the cover: K	Green areas, walkways, roadways - max. 125 kN	For sewage system fittings
9513	Round, cover made of grey or ductile cast iron, body made of PEHD, indication on the cover: none	Green areas, walkways, roadways - max. 125 kN	Universal
9514	Square, cover made of grey cast iron, body made of PEHD, indication on the cover: GAZ	Green areas	For adapter fittings

Street installation boxes consist of a body made of high density polyethylene (PEHD) and cover made of grey cast iron (EN-GJL 200) or plastic (9504-PEHD-PEHD). The cover is connected with the body using a pin made of anodised structural steel, galvanised carbon steel or stainless steel. The cover is fitted with a lug used to engage a hoisting hook.

The box dimensions comply with the PN-M-74081:1998 standard, i.e. “Street boxes applicable in water and gas supply systems” and PN-M-74082:1998 standard, i.e. “Street boxes for hydrants”.

Table 2

Cat. no.	Height	Cover diameter	Base diameter
9501	270	156	270
9502	310	337/234	420/315
9503	250	119	200
9504	150	104	170
9505	150	104	170
9506	270	156	270
9507	270	156	270
9508	310	337/234	420/315
9509	295/470	156	270
9511	270	156	270
9512	270	156	270
9513	270	156	270
9514	250	119	200

Dimensions in mm

3. PRODUCT IDENTIFICATION

“W” for water pipeline gate valves and adapter fittings for water pipeline connections;



“HYDRANT” for underground hydrants;



“GAZ” for gas system gate valves; and



“K” for sewage system fittings.
Other type available on request

Street installation box identification:

TH-95XX-YYYY-ZZZZ

TH-95XX – box type

YYYY – body material, e.g. PEHD, GJL

ZZZZ – cover material, e.g. PEHD, GJL

4. STORAGE AND TRANSPORT

The products are supplied on EURO pallets (1,200 x 800 mm). Street installation boxes must be stored in clean rooms, at temperatures from -20 to +70°C. Plastic elements must be protected against prolonged exposure to UV radiation. Store elements ensuring protection against mechanical damage. Secure the products against shifting during shipping and handling.

5. INSTALLATION

Before installing a box, ensure it complies with the data provided in an order. Next, prepare the box foundation surface in an excavation and check its depth. While installing a box, check its intended use against operating parameters of the installation location, in particular the type of pavement in relation to its maximum resistance to loads.

Any change in the operating conditions must be consulted with the manufacturer beforehand.

Street installation boxes must be mounted on plastic base plates dedicated for a given box type. It is permissible to install boxes directly on the native soil or sandy bedding material, depending on the current soil conditions.

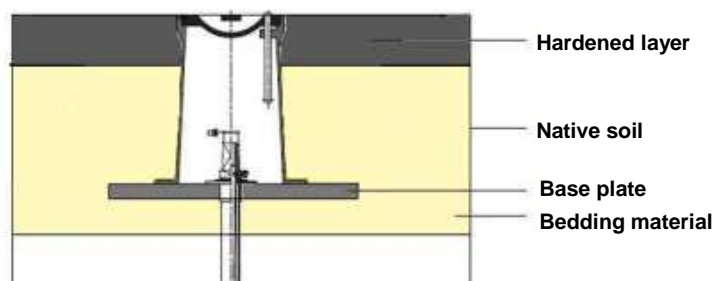

In order to install a street box, proceed as follows:

- Make an excavation.
- Level the excavation bottom. Remove large and sharp rocks.

- Prepare a 5 cm thick sandy bedding material layer,
- Place a base plate compatible with a given box type.
- Locate a street box on the bedding material.
- Gradually cover the base plate with soil layers and thicken them around the whole box circumference.
- Ensure the thickening degree is correct in relation to soil and water conditions and further external loads.
- Lay an external hardened layer, e.g. concrete, paving blocks (if outside a green area).

6. OPERATION AND MAINTENANCE

The street box design is basically maintenance-free, however, in order to ensure the longest possible period of trouble-free operation, boxes must be annually inspected. Such inspections consist in assessing its completeness and checking for possible mechanical damage.

In case a box pin or cover is damaged, a repair set can be fixed, without removing its body from the ground.

Corrosion on cast iron elements of a box is permissible. It is only natural that, in the course of intensive operation, a layer of paint is removed from the cover surface. Nevertheless, grey cast iron from which a cover is made is subject to surface corrosion which, after releasing iron oxides, will limit further core corrosion. Street installation box elements can be recycled (after cleaning).

7. SAFETY

All installation and operation tasks related to the product shall be only be done by qualified professionals with sufficient training and experience to assess the current situation and identify and avoid hazards. Failure to follow this warning or this Operating Manual may cause death, severe bodily injury or substantial property damage.

Fabryka Armatur Jafar S.A. shall not be liable for any accidents or emergencies related to incorrect installation or operation of the product. Note that the valve installation could be pressurized or contain various type of stray gas or aggressive liquids. If the installation is operated explosion hazard zones, ATEX requirements may apply; this will require suitably trained professionals (according to ATEX requirements). Do not use tools which may generate electrostatic discharge in the ATEX zone.

Do not use the product without thorough knowledge and understanding of this Operating Manual. Follow the general health and safety rules. Keep this Operating Manual throughout the service life of the product to ensure a safe operation of the latter.

8. WARRANTY

The product assembled, installed and operated in compliance with this Operating Manual and the Product Specification Sheet is covered by a commercial warranty from the manufacturer. The warranty terms, conditions and period are specified in the Warranty Certificate available from www.jafar.com.pl.

The manufacturer may provide this product with custom materials and modifications on order. The final selection of the product meeting the optimal criteria for a given installation is performed by the designer taking into account, apart from the operating instruction, all the other possessed data and information that may affect the correct operation of the device.

Failure to comply with the guidelines and instructions in this Operation and Maintenance Manual releases the manufacturer from all obligations, liability and warranty. Due to continuous business development, the manufacturer reserves the right to modify and change the design of the product shown herein.